

**Land Grant Map**  
 Dobbersville Quadrangle  
 Sampson, Duplin, and Wayne Counties, North Carolina

Researched and drawn by Thomas M. Byrd,  
 903 Washington Street, Cary, NC 27511  
 (919) 467-9848 [tombyrd@earthlink.net](mailto:tombyrd@earthlink.net)

John Grantham

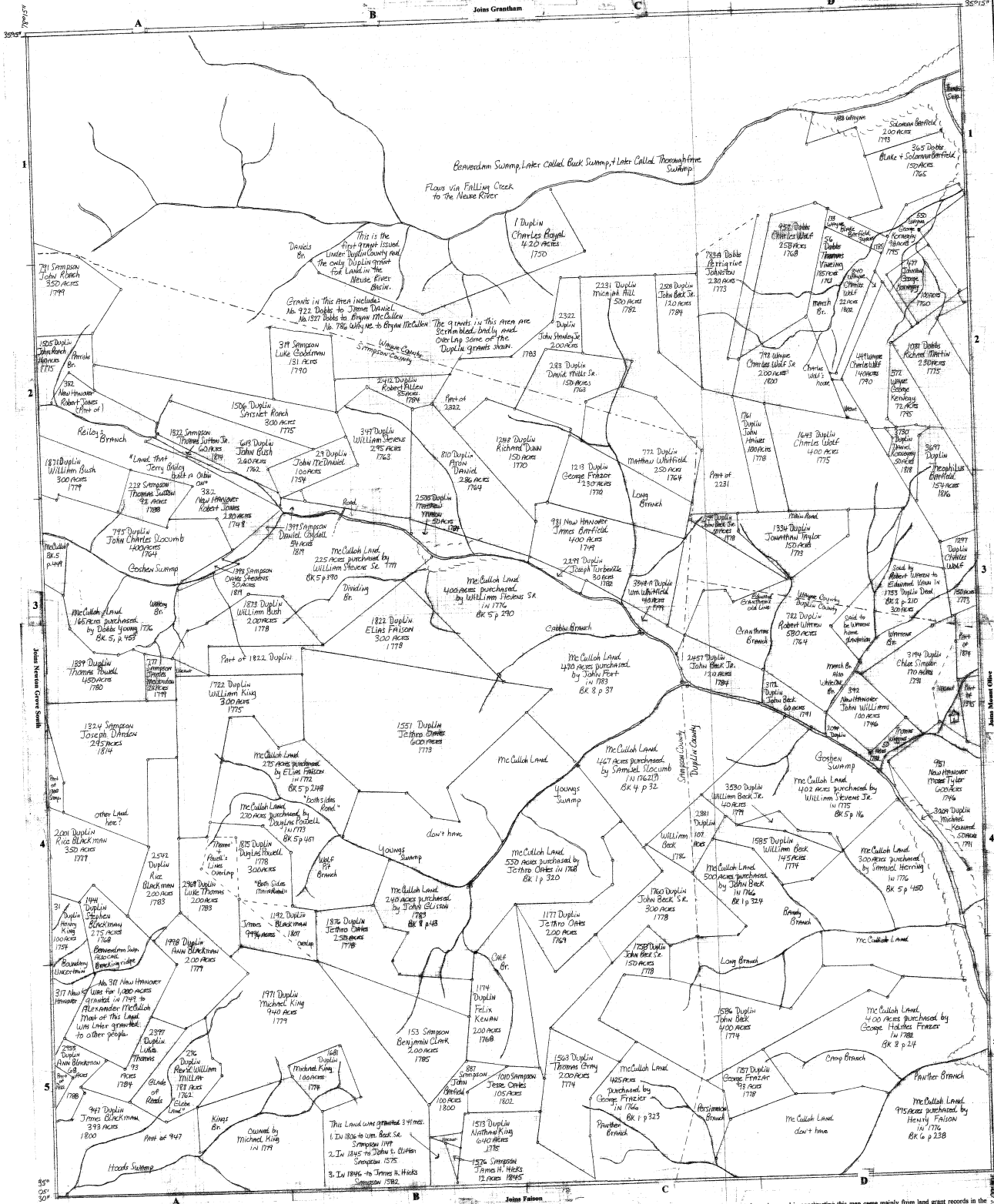

Written on most plots are five bits of information: the file number for the grant, the county under which the grant was issued, the name of the grantee, the acreage, and the year the grant was issued. Deed books are cited in cases where grants have not been found or where the boundaries of grants cannot be determined.

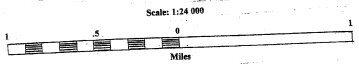

Information used in constructing this map came mainly from land grant records in the North Carolina Department of Archives and History in Raleigh and from Duplin and Sampson County deed books. The location of waterways was determined from a U.S. Geological Survey map for a quadrangle of the same name. Names shown for the waterways were taken from land grants, not from the USGS map.